

G108

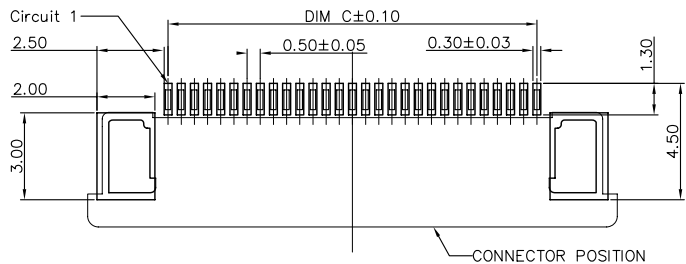

RECOMMENDED P.C.B PATTERN LAYOUT

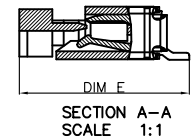
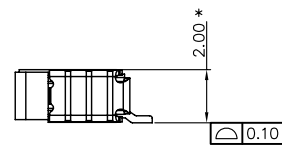
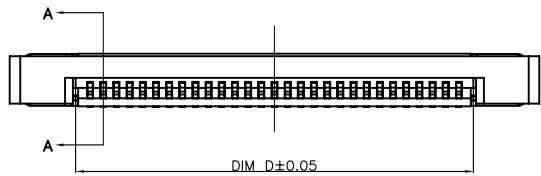
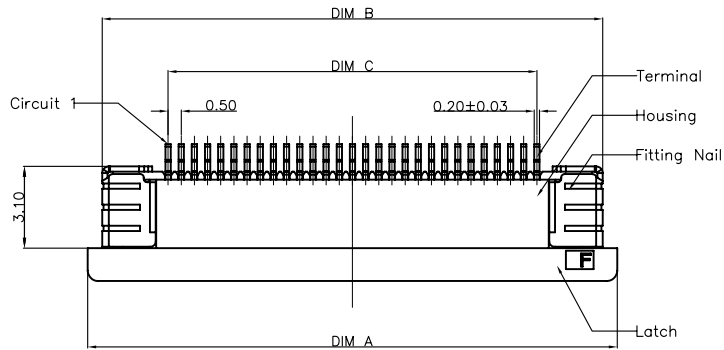
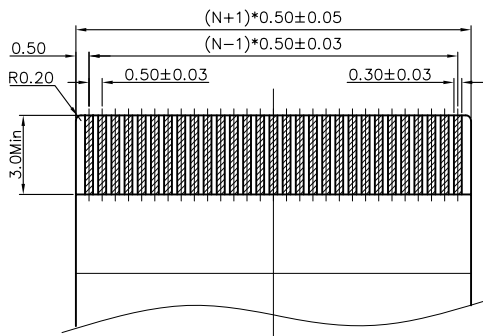

RECOMMENDED FPC/FFC DIMENSION

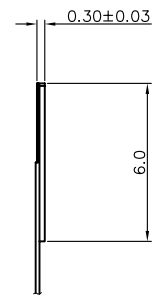

PART NO. LEGEND:
F2BXXU-A1X3-EB

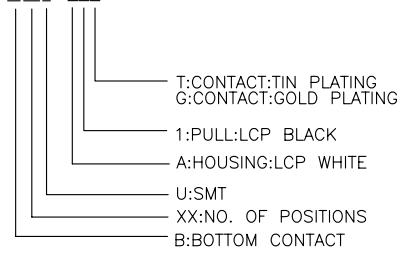

- Note:
- Material:
 - Housing: thermoplastic high temp.UL94V-0; Color: natural.
 - Latch: thermoplastic high temp.UL94V-0; Color: black.
 - Terminal: copper alloy.
 - Fitting Nail: copper alloy.
 - Finish:
 - Terminal: Underplating: Au/matt Tin overall.
 - Fitting Nail: Underplating: matt Tin overall.

▲ Non-tooled parts
NO.OF POSITIONS DIM LIST:

PIN	DIM=A	DIM=B	DIM=C	DIM=D	DIM=E
60P	35.60	34.50	29.50	30.60	
▲ 59P	35.10	34.00	29.00	30.10	
▲ 58P	34.60	33.50	28.50	29.60	
57P	34.10	33.00	28.00	29.10	
▲ 56P	33.60	32.50	27.50	28.60	
55P	33.10	32.00	27.00	28.10	
54P	32.60	31.50	26.50	27.60	
53P	32.10	31.00	26.00	27.10	
52P	31.60	30.50	25.50	26.60	
51P	31.10	30.00	25.00	26.10	
50P	30.60	29.50	24.50	25.60	
49P	30.10	29.00	24.00	25.10	
48P	29.60	28.50	23.50	24.60	
47P	29.10	28.00	23.00	24.10	5.70
▲ 46P	28.60	27.50	22.50	23.60	
45P	28.10	27.00	22.00	23.10	
44P	27.60	26.50	21.50	22.60	
43P	27.10	26.00	21.00	22.10	
42P	26.60	25.50	20.50	21.60	
41P	26.10	25.00	20.00	21.10	
40P	25.60	24.50	19.50	20.60	
▲ 39P	25.10	24.00	19.00	20.10	
38P	24.60	23.50	18.50	19.60	
37P	24.10	23.00	18.00	19.10	
36P	23.60	22.50	17.50	18.60	
35P	23.10	22.00	17.00	18.10	

G	E			DRAWING:	GENERAL TOLERANCE			
	D			Frank	.X: = ±0.15	.X*: = ±5°		
C	C			CHECKED:	.XX: = ±0.10	.XX*: = ±3°	DESCRIPTION: 0.5mm PITCH FPC CONN. H2.0mm Bottom CONTACT	
	B			Tony	.XXX: = ±0.05	.XXX*: = ±1°		
H	A			APPROVAL:	UNIT: MM	PROJECTION:	PART NO: F2BXXU-A1X3-EB REV: 1.0	
	NO.	DATE	DESCRIPTION	yang jie	SCALE: 1/1			DRAWING NO: SIZE: A4
	1	2	3	4	5	6	7	