

ROHS G103

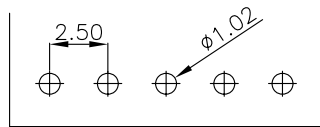

RECOMMENDED PCB LAYOUT
(TOLERANCE:±0.05)

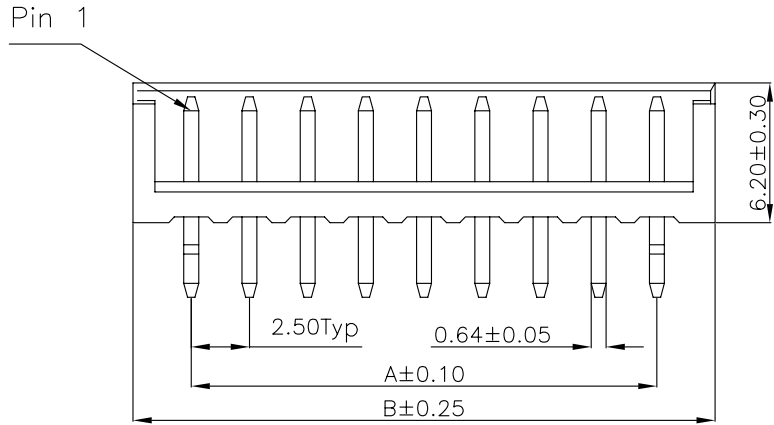
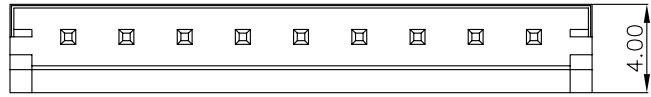
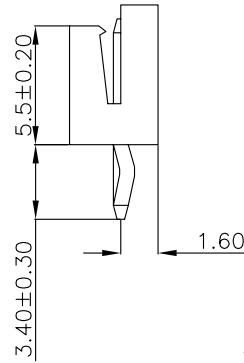

1.ELECTRICAL SPECIFICATIONS:

- 1.1 Rated current and voltage(额定电流):
3.0A 250V AC(r.m.s)
- 1.2 Dielectric Withstanding Voltage(耐电压) :
1000V AC for one minute
- 1.3 Contact Resistance(接触电阻) :
20mΩ max
- 1.4 Insulation Resistance(绝缘电阻) :
1000MΩ min
- 1.5 Operating Temperature(工作温度) :
-25℃ ~ 85℃

2.MATERIAL SPECIFICATION:

- 2.1 Insulator Material(绝缘体材质):
PA66 (nature)
- 2.2 Contact Material(端子材质):
Brass
- 2.3 Applicable wire:28AWG TO 22AWG

PART NO. LEGEND:
WB2502DS-XXT2

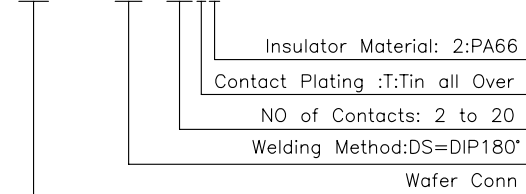

▲ Non-tooled parts
No.of positions DIM list:

CONTACTS	DIMENSIONS	
	A	B
2	2.50	7.50
3	5.00	10.00
4	7.50	12.50
5	10.00	15.00
6	12.50	17.50
7	15.00	20.00
8	17.50	22.50
9	20.00	25.00
10	22.50	27.50
11	25.00	30.00
12	27.50	32.50
13	30.00	35.00
14	32.50	37.50
15	35.00	40.00
16	37.50	42.50
17	40.00	45.50
18	42.50	47.50
19	45.00	50.00
20	47.50	52.50

E				DRAWING:	GENERAL TOLERANCE		
D				Hu yatao	.X:=±0.30	.X':=±2°	
C				CHECKED:	.XX:=±0.20	.XX':=±1°	DESCRIPTION: 2.50mm Pitch Top Entry Type EH
B				Tony	.XXX:=±0.10	.XXX':=±0.5°	
A				APPROVAL:	UNIT: MM	PROJECTION:	PART NO: WB2502DS-XXT2 REV: 1.0 CUSTOMER NO: SIZE: A4
NO.	DATE	DESCRIPTION	APPROVAL	Yang jie	SCALE: N/A		
					SHEET: 1/1		

ROHS G103

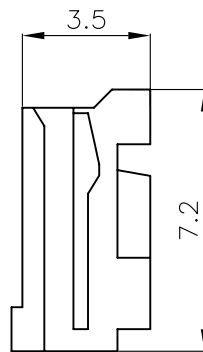
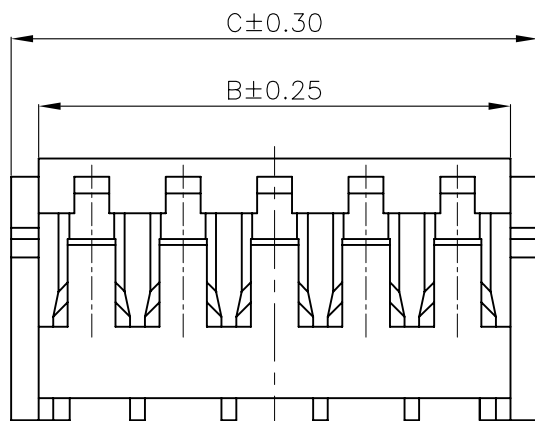
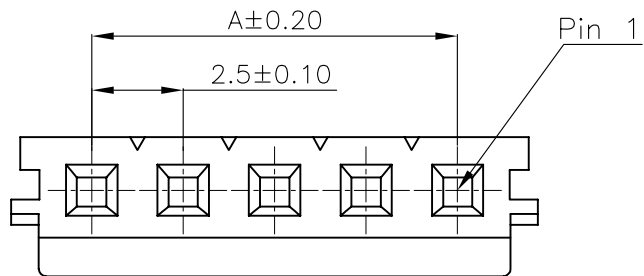

1.ELECTRICAL SPECIFICATIONS:

- 1.1 Rated current and voltage(额定电流):
2.5A 250V AC(r.m.s)
- 1.2 Dielectric Withstanding Voltage(耐电压) :
800V AC for one minute
- 1.3 Contact Resistance(接触电阻) :
10mΩ max
- 1.4 Insulation Resistance(绝缘电阻) :
1000MΩ min
- 1.5 Operating Temperature(工作温度) :
-25°C ~ 85°C

2.MATERIAL SPECIFICATION:

- 2.1 Insulator Material(绝缘体材质):
PA66,UL94V-0(nature)
- 2.2 Applicable wire:28AWG-22AWG

▲ Non-tooled parts
No.of positions DIM list:

CONTACTS	DIMENSIONS		
	A	B	C
2	2.50	5.40	7.00
3	5.00	7.90	9.50
4	7.50	10.40	12.00
5	10.00	12.90	14.50
6	12.50	15.40	17.00
7	15.00	17.90	19.50
8	17.50	20.40	22.00
9	20.00	22.90	24.50
10	22.50	25.40	27.00
11	25.00	27.90	29.50
12	27.50	30.40	32.00
13	30.00	32.90	34.50
14	32.50	35.40	37.00
15	35.00	37.90	39.50
16	37.50	40.40	42.00
17	40.00	42.90	44.50
18	42.50	45.40	47.00
19	45.00	47.90	49.50
20	47.50	50.40	52.00

PART NO. LEGEND:
WB2502DSH-XXP2

Insulator Material: 2:PA66

NO of Contacts: 2 to 20

H:Housing

Wafer Conn

DRAWING:
Hu yatao

CHECKED:
Tony

APPROVAL:
Yang jie

GENERAL TOLERANCE

.X:=±0.30 .X':=±2°
.XX:=±0.25 .XX':=±1°
.XXX:=±0.15 .XXX':=±0.5°

UNIT: MM

SCALE: N/A

SHEET: 1/1

PROJECTION:

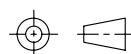

CHIN-BAN
electronics (H.K.) co., ltd

DESCRIPTION:

2.50mm Pitch Housing Single Row(EH)

PART NO: WB2502DSH-XXP2

REV: 1.0

CUSTOMER NO:

SIZE: A4

E			
D			
C			
B			
A			
NO.	DATE	DESCRIPTION	APPROVAL

ROHS G103

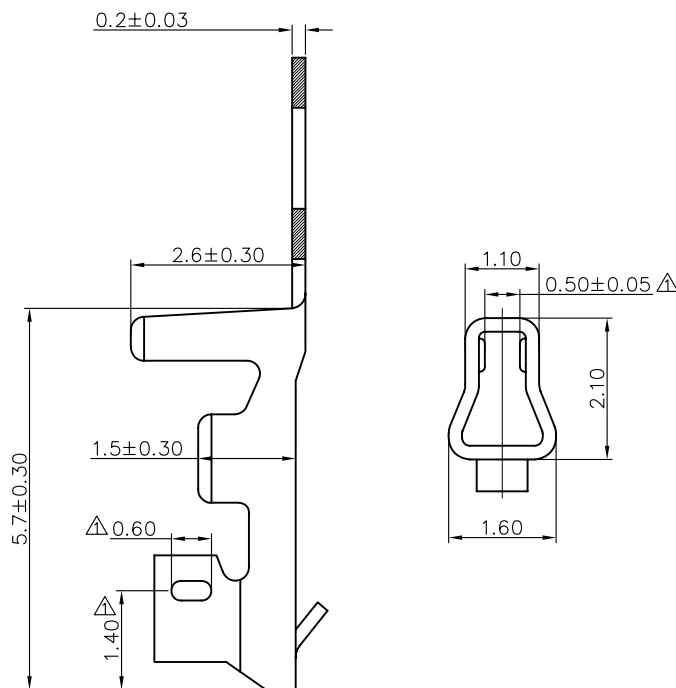
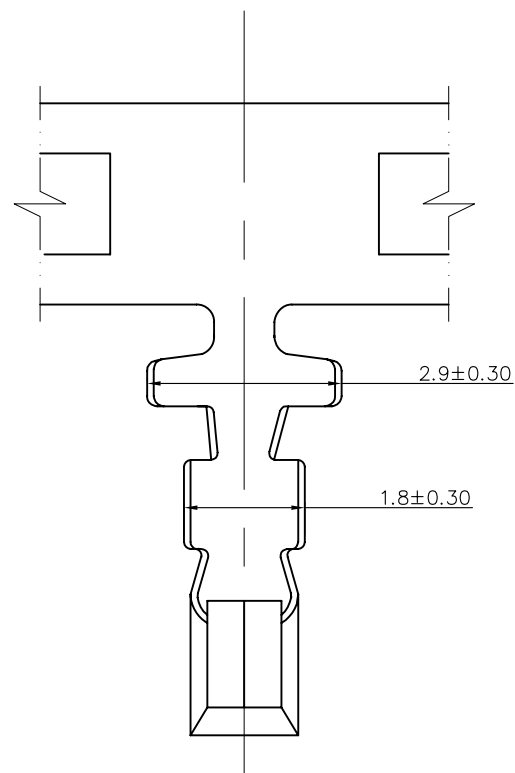

1.ELECTRICAL SPECIFICATIONS:

- 1.1 Rated current and voltage(额定电流):
3.0A 250V AC(r.m.s)
- 1.2 Dielectric Withstanding Voltage(耐电压) :
1000V AC for one minute
- 1.3 Contact Resistance(接触电阻) :
20mΩ max
- 1.4 Insulation Resistance(绝缘电阻) :
1000MΩ min
- 1.5 Operating Temperature(工作温度) :
-25°C ~ 85°C
- 1.6 Material:
Phosphor Bronze (UL94V-0); Tin
- 1.7 Applicable wire:28AWG-22AWG

PART NO. LEGEND:
WB2502DST-T2

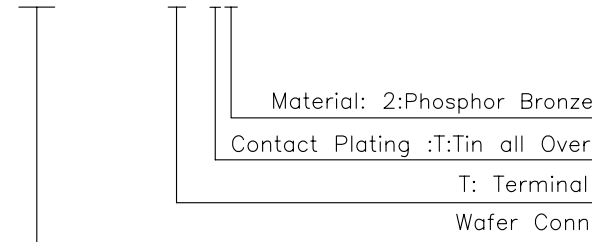

DRAWING:
Hu yatao

GENERAL TOLERANCE

.X:=±0.30 .X':=±2°
.XX:=±0.20 .XX':=±1°
.XXX:=±0.10 .XXX':=±0.5°

CHECKED:
Tony

UNIT: MM

PROJECTION:

APPROVAL:
Yang jie

SCALE: N/A

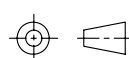

SHEET: 1/1



CHIN-BAN
electronics (H.K.) co., ltd

DESCRIPTION:

2.50mm Pitch Terminal

PART NO: WB2502DST-T2

REV: 2.0

CUSTOMER NO:

SIZE: A4

E				
D				
C				
B				
A	15.12.18	△ Add size	Huyatao	
NO.	DATE	DESCRIPTION	APPROVAL	