

G108

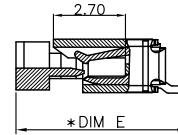

SECTION A-A
SCALE 1:1

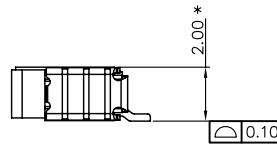
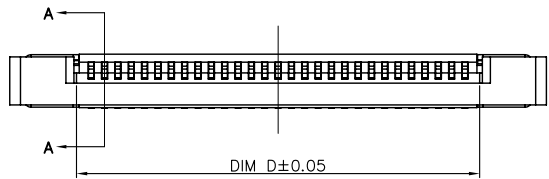
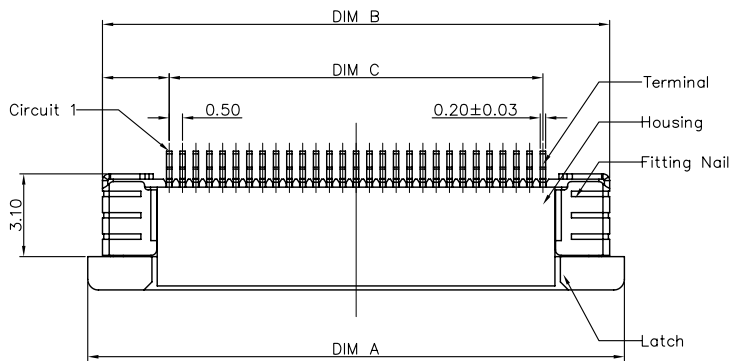
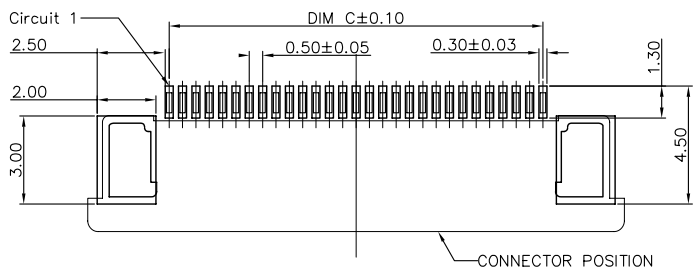

RECOMMENDED P.C.B PATTERN LAYOUT

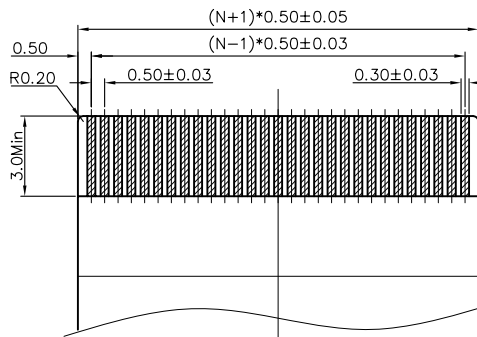

RECOMMENDED FPC/FFC DIMENSION

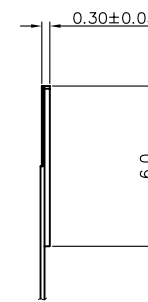

PART NO. LEGEND:
F2TXXU-A1X3-E

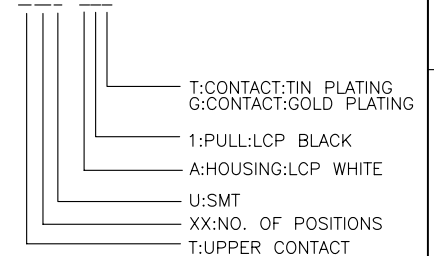

Note:

1. Material:
 - 1.1 Housing: thermoplastic high temp.UL94V-0; Color: natural.
 - 1.2 Latch: thermoplastic high temp.UL94V-0; Color: black.
 - 1.3 Terminal: copper alloy.
 - 1.4 Fitting Nail: copper alloy.
2. Finish:
 - 2.1 Terminal: Underplating: Au/matt Tin overall.
 - 2.2 Fitting Nail: Underplating: matt Tin overall.

▲ Non-tooled parts
NO.OF POSITIONS DIM LIST:

34P	22.60	21.50	16.50	17.60	
33P	22.10	21.00	16.00	17.10	
32P	21.60	20.50	15.50	16.60	
31P	21.10	20.00	15.00	16.10	
30P	20.60	19.50	14.50	15.60	
29P	20.10	19.00	14.00	15.10	
28P	19.60	18.50	13.50	14.60	
27P	19.10	18.00	13.00	14.10	
26P	18.60	17.50	12.50	13.60	
25P	18.10	17.00	12.00	13.10	
24P	17.60	16.50	11.50	12.60	
23P	17.10	16.00	11.00	12.10	
22P	16.60	15.50	10.50	11.60	
21P	16.10	15.00	10.00	11.10	
20P	15.60	14.50	9.50	10.60	
19P	15.10	14.00	9.00	10.10	
18P	14.60	13.50	8.50	9.60	
17P	14.10	13.00	8.00	9.10	
16P	13.60	12.50	7.50	8.60	
15P	13.10	12.00	7.00	8.10	
14P	12.60	11.50	6.50	7.60	
13P	12.10	11.00	6.00	7.10	
12P	11.60	10.50	5.50	6.60	
11P	11.10	10.00	5.00	6.10	
10P	10.60	9.50	4.50	5.60	
9P	10.10	9.00	4.00	5.10	
8P	9.60	8.50	3.50	4.60	
7P	9.10	8.00	3.00	4.10	
6P	8.60	7.50	2.50	3.60	
5P	8.10	7.00	2.00	3.10	
4P	7.60	6.50	1.50	2.60	
PIN	DIM=A	DIM=B	DIM=C	DIM=D	DIM=E

5.20

E			
D			
C			
B			
A			
NO.	DATE	DESCRIPTION	APPROVAL
1			
2			
3			

DRAWING:
Frank

CHECKED:
Tony

APPROVAL:
yang jie

GENERAL TOLERANCE
.X:=±0.15 .X°:=±5°
.XX:=±0.10 .XX°:=±3°
.XXX:=±0.05 .XXX°:=±1°

UNIT: MM

SCALE: 1/1

SHEET: 1/1

PROJECTION:

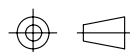

CHIN-BAN
electronics (H.K) co., ltd

DESCRIPTION:
0.5mm PITCH FPC CONN. H2.0mm UPPER CONTACT

PART NO: F2TXXU-A1X3-E

DRAWING NO:

REV: 1.0

SIZE: A4